

CG70 repair airbags operation guide and tips

01 Airbag module must place face up (the label is facing up)

Cars generally have multiple crash sensors installed in the front and middle of the car body. However, with the development of technology, some car companies have been able to build crash sensors into the airbag module to monitor vehicle operation more accurately.



What we mean by putting it face up (with the label facing up) is to simulate the normal driving state of the car. In this case, the fault code can be cleared correctly, otherwise the light may still be on when the car is loaded.

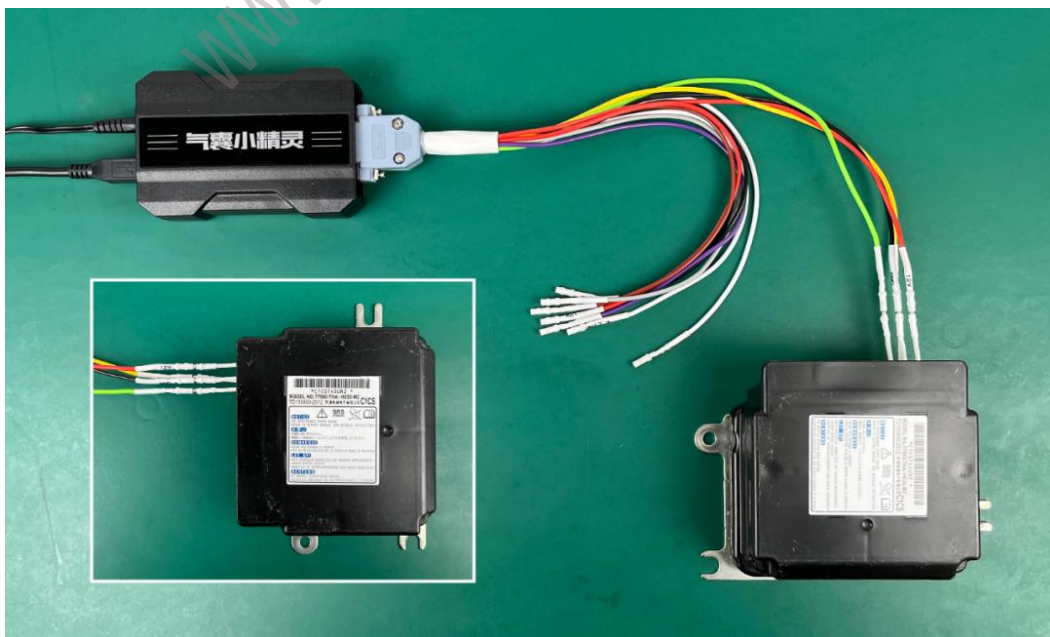

02 Do not touch cables while operating

Do not touch the communication cables while the equipment is in operation. If any one cable is disconnected, the repair will fail and data may even be lost. In a worst-case scenario, the airbag module chip is locked and the vehicle cannot communicate.



When some airbag ecu are being repaired, the CG70 will read the original EEPROM data, which must be saved for subsequent maintenance.

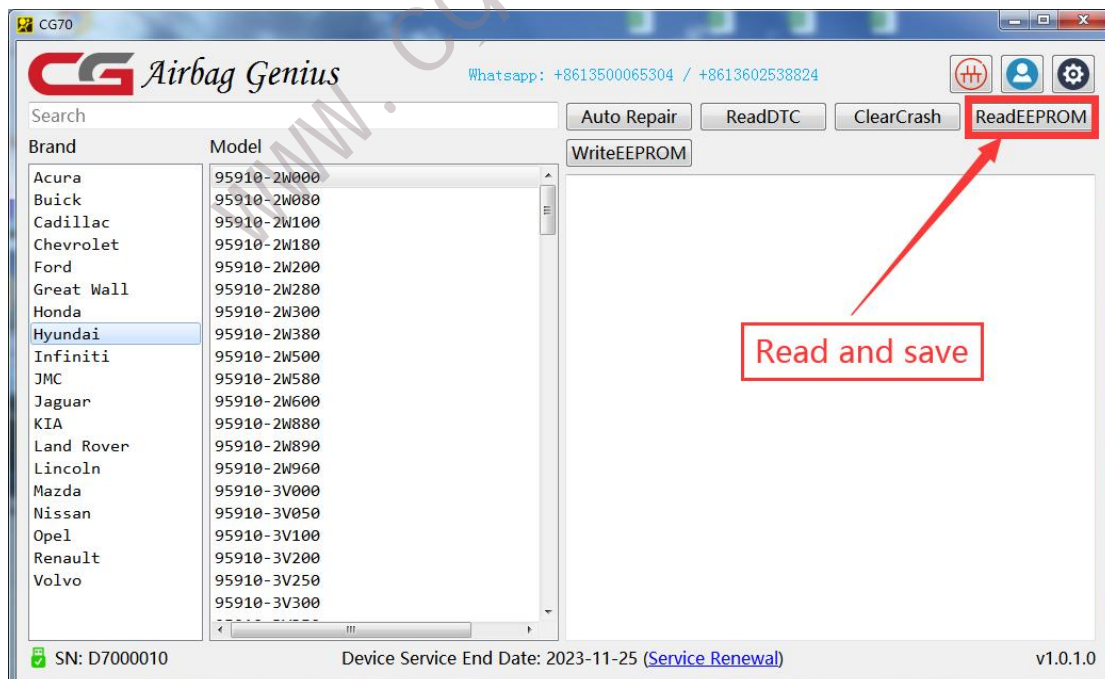

03 Stand the airbag for 5 minutes to discharge capacitor

After the airbag computer is repaired, unplug the 12V power supply of the device first. Then remove the wiring cables, to avoid data loss caused by operation in the power-on state.

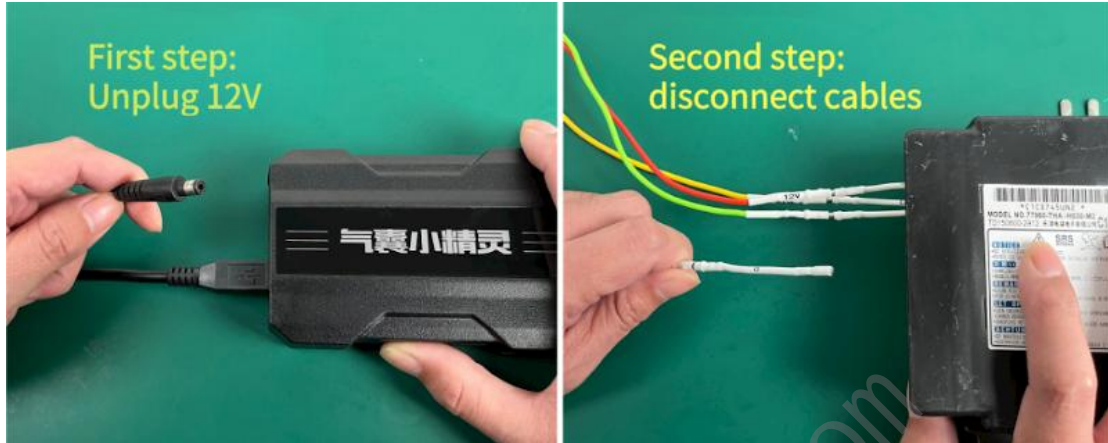

Do not move the airbag module after CG70 has been repaired successfully. let it stand for five minutes after the power is turned off. The purpose is to discharge the capacitor to prevent damage to components.

